

DRG. No. LPBE-868-2SP

© 2018 A4

THIS DOCUMENT MUST NOT BE COPIED OR DISCLOSED TO A THIRD PARTY WITHOUT THE WRITTEN CONSENT OF PANORAMA ANTENNAS LTD.

DO NOT SCALE

△ DENOTES LATEST ISSUE CHANGES

○ DENOTES CRITICAL VALUE

PROJECTION

TOLERANCES UNLESS OTHERWISE STATED			
0 DEC. PLACE	±0.5	2 DEC. PLACES	±0.1
1 DEC. PLACE	±0.2	ANGULAR	±1°

FREQUENCIES:
868 MHz

NOTES:

- SAMPLES MUST BE APPROVED BY PANORAMA ANTENNAS Q.C. BEFORE COMMENCING PRODUCTION.
- ALL MATERIALS SUPPLIED MUST BE RoHS2 (DIRECTIVE 2011/65/EU) COMPLIANT AND MUST NOT CONTAIN ANY SUBSTANCES OF VERY HIGH CONCERN (SVHCs) LISTED UNDER REACH OR POLY-AROMATIC HYDROCARBONS (PAHs), OR PERSISTENT ORGANIC POLLUTANTS (POPs) CONTROLLED BY THE STOCKHOLM CONVENTION.

A
B
C
D
E
F

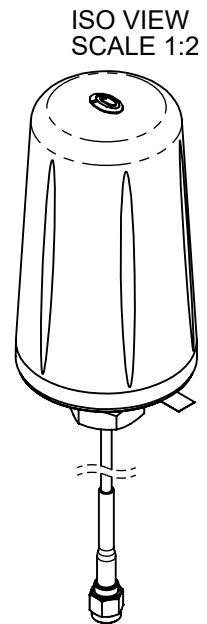
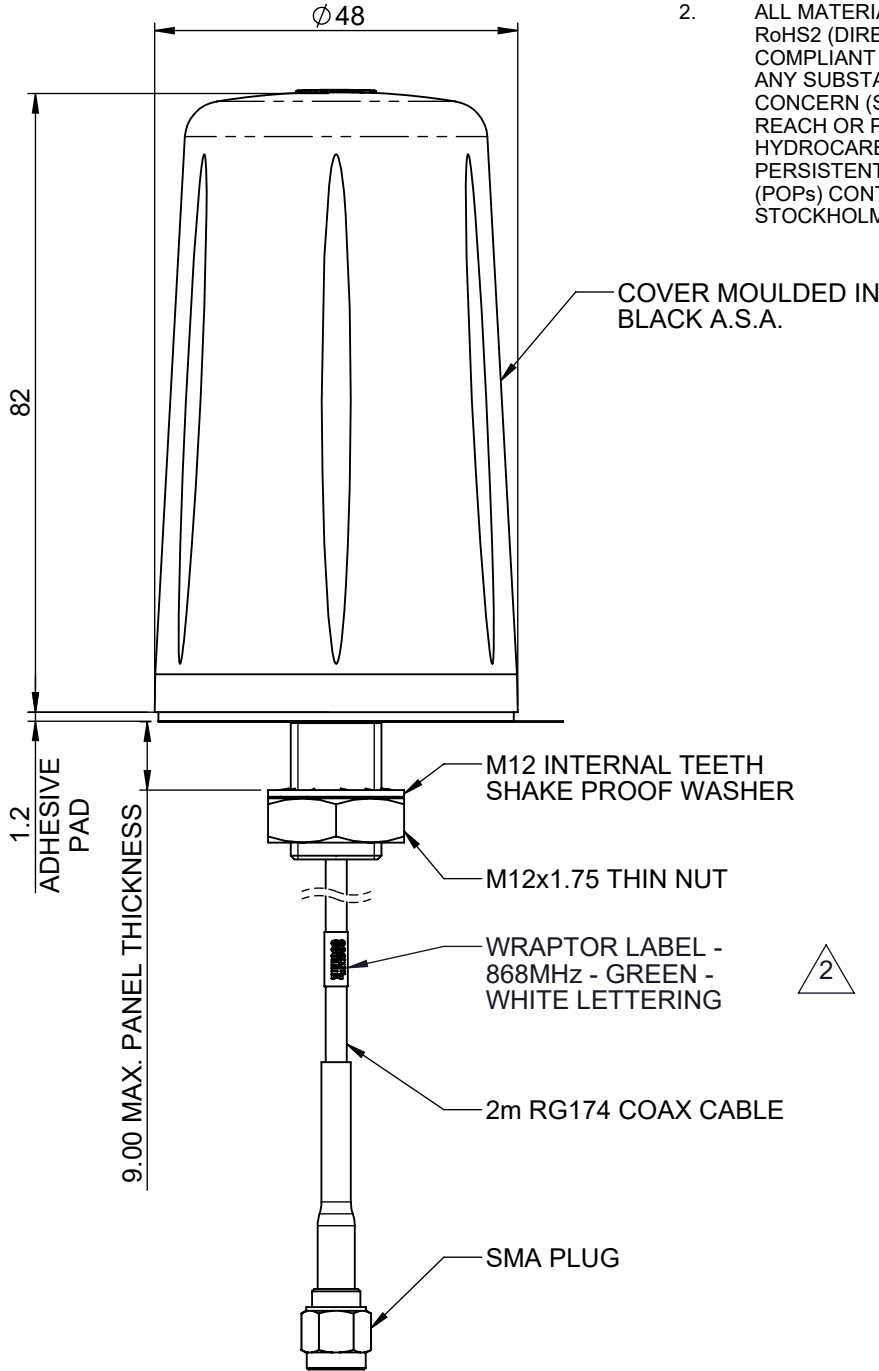
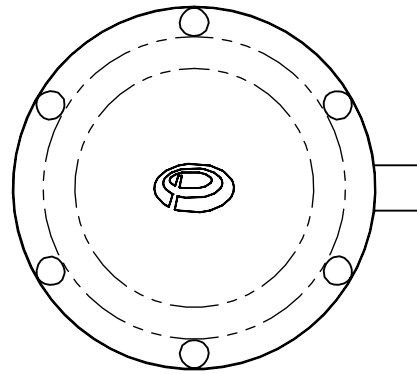

PRODUCT/ASSEMBLY					DESCRIPTION						
M2M LOW PROFILES					LOW PROFILE ANTENNA 868MHz 2m SMAP						
MATERIAL					FINISH						
N/A					N/A						
01019	1	PRODUCTION ISSUE	31/05/2018	PE	APPROVED	KD	D.O.CHECK	MM	SCALE	1:1	DIMENSIONS IN mm
01019	2	WRAPTOR LABEL SHOWN	04/07/2018	IC							
PCN	REV.	DESCRIPTION	DATE	DRN	WEIGHT	146g		SHEET 1 OF 1			