

INFORMATION

RELEASE 14.12.2015

4299.06

4m/2m- Band, TETRA 3dB; GPS



Dachantenne



Roof Mount Antenna

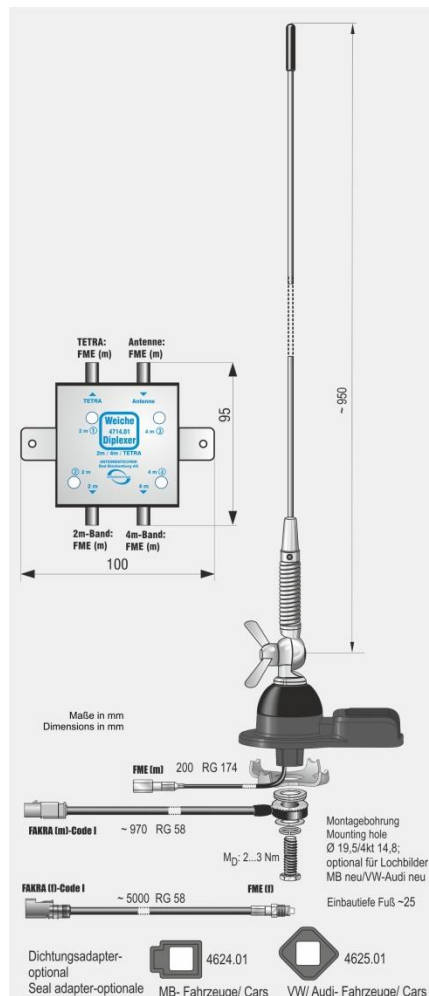
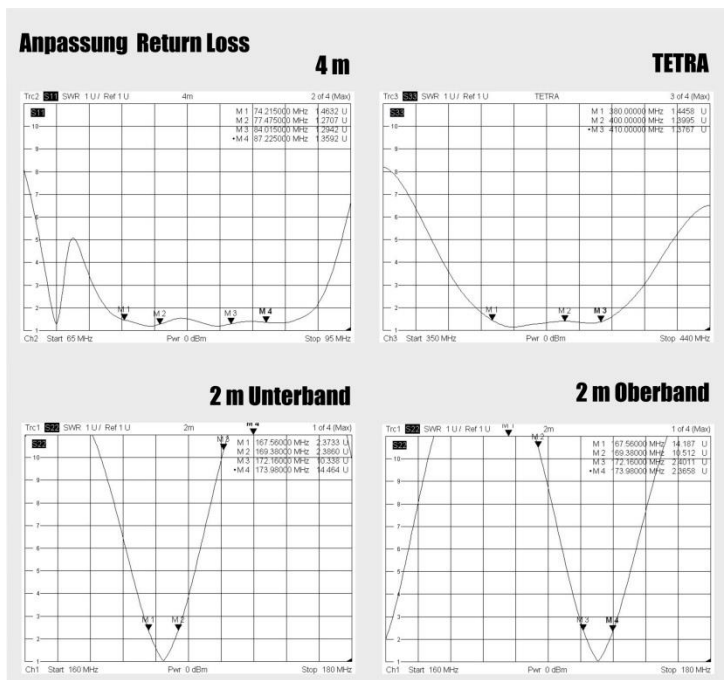

Ersatzstrahler: **4718.010**

| Frequenzbereich | Frequency Range | 4m | 2m | TETRA | GPS |
|-----------------|-----------------|--------------------------|-----------------|-------------|-------------|
| Frequenz | Frequency | 73-87,5 MHz | 167-174 MHz | 380-410 MHz | 1575,42 MHz |
| Bandbreite | Spectrum | | Ober-/Unterband | | |
| Impedanz | Impedance | 50Ω | | | |
| Gewinn | Gain | 0 dB * | 0 dB * | 3 dB * | 30 dBic typ |
| max. Leistung | max. Power | 25 W | | | |
| Anpassung | VSWR | ≤ 1,5 : 1 | ≤ 2,0 : 1 | ≤ 2,0 : 1 | ≤ 1,5 : 1 |
| Verstärkung LNA | Amplif. LNA | 28 ± 3 dB | | | |
| Rauschmaß | Noise Figure | 1,7 dB typ. | | | |
| Stromversorgung | Power supply | +3,0...5,0 V, 10...30 mA | | | |
| Kabel RG 174 | Cable RG 174 | 0,2 m | | | |
| Steckverbinder | Connector | FME(m) | FME(m) | FME(m) | FME(m) |

*) bezogen auf λ/4-Element referring to λ/4-element

Irrtümer und technische Änderungen vorbehalten – Errors and technical changes reserved